

SPECIFICATIONS

CONTACT RATING: Dependent upon contact material.
MECHANICAL LIFE: 30,000 make-and-break cycles.
CONTACT RESISTANCE: 20mΩ max. initial @ 2-4VDC
 100mA for both silver and gold plated contacts.
INSULATION RESISTANCE: 1,000MΩ min.
DIELECTRIC STRENGTH: 1,000 V RMS@sea level.
OPERATING TEMPERATURE: -30° C to 85° C

MATERIALS

CASE & BUSHING - Glass filled nylon 4/6, flame retardant, heat stabilized (UL 94V-0)
ACTUATOR - Brass, chrome plated, internal O-ring seal. Standard for all actuators.
SWITCH SUPPORT - Brass, tin plated.
CONTACT/TERMINALS - Copper alloy, with Silver or gold plated. (See Page 40)

HOW TO ORDER

MODEL NO. ACTUATOR BUSHING TERMINATIONS CONTACT MATERIAL SEAL ROHS SOLDERING

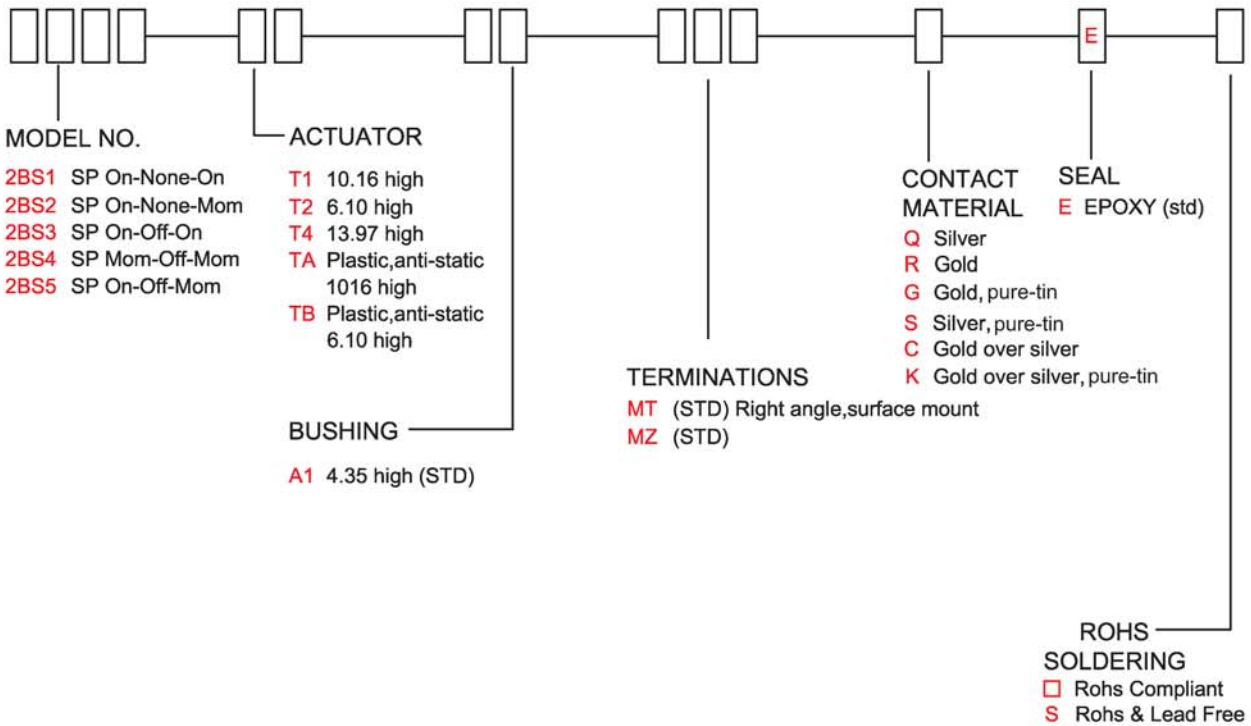

SWITCH FUNCTION

NO. POLES	UL-CSA	MODEL NO.	SWITCH FUNCTION			CONNECTED TERMINALS / SCHEMATIC		
			POS.1	POS.2	POS.3	POS.1	POS.2	POS.3
SP	Q22B11	2BS1	ON	NONE	ON	2-3 	OPEN	2-1
	Q22B12	2BS2	ON	NONE	MOM			
	Q22B13	2BS3	ON	OFF	ON			
	Q22B14	2BS4	MOM	OFF	MOM			
	Q22B15	2BS5	ON	OFF	MOM			

POLE OPTIONS

MT

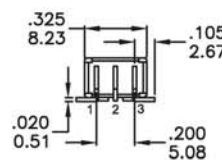
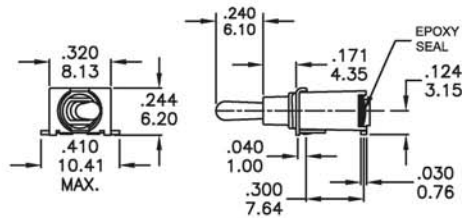

P.C. MOUNTING

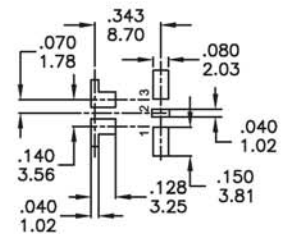

SPDT

Part No. shown : 2BS1T2A1MTRE

MZ

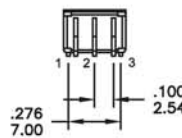
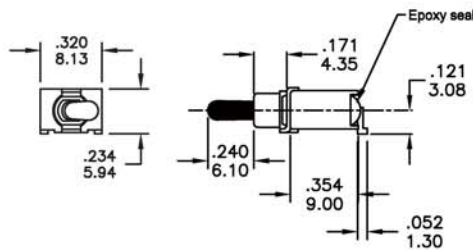

P.C. MOUNTING

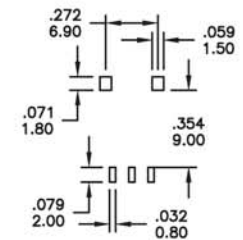

SPDT

Part No. shown : 2BS1TBA1MZRE

ACTUATOR OPTIONS

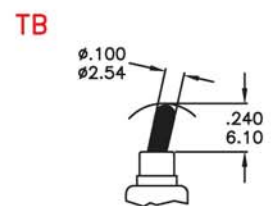
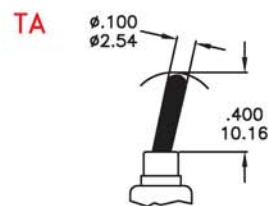
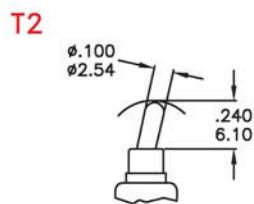
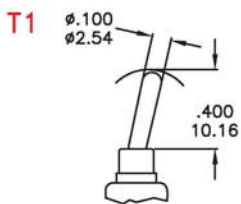

ESD
PLASTIC ACTUATOR

PACKAGING

Switches available on embossed antistatic tape and reels.
Tape and cover strip are conductive for use near statically sensitive components.

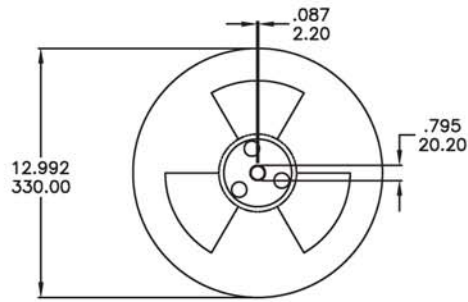

SCALE: 10 : 1

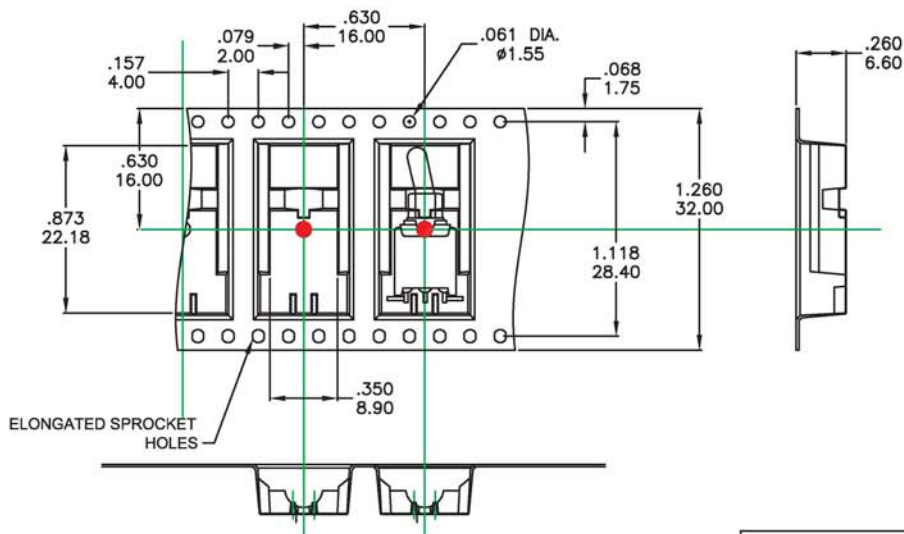
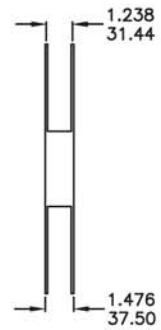

SCALE: 1 : 1

REEL INFORMATION	
QUANTITY PER REEL	500 PCS

CONTACT MATERIAL OPTIONS

	CONTACT MATERIAL	TERMINATION RATING	RATINGS
Q	Silver	Q = Gold flash over silver	3 Amps with resistant load @ 120VAC or 28VDC 1 Amps with resistant load @ 250VAC
S		S = Gold flash over silver,pure - tin	
C	Gold over Silver	C = Gold over silver	
K		K = Gold over silver,pure - tin	
R	Gold	R = Gold	0.4 Volt-Amps(VA)max. @ 20V max. (AC or DC)
G		G = Gold,pure - tin	



IP 67
ACCORDING TO
EN 60529:1991+A1:2001
IEC 60529:2001

SOLDERING PROCESSES

WAVE SOLDERING : Recommended Soldering Temperature:260±5°C
Duration of Solder Immersion: 5 ±1 seconds
(PCB is 1.6mm in thickness)

SOLDERING : Vapor phase & IR- reflow soldering can be applied.

Temperature Profile

Zone	Room temperature	Time (Sec)
Pre-heat (A)	150°C	Min 120s
Soak (B)	180°C~200°C	Min 150s
Peak (C)	200°C~235°C	Min 30s
Peak (D)	235°C~260°C	Min 40s
Peak (E)	260°C	Max 10s

